

# PLAT OF SURVEY

LOT 81, STERLING OAKS ADDITION NO. 1, being a part of the Northwest 1/4 and Southwest 1/4 of the Northeast 1/4 and a part of the Northeast 1/4 and Southeast 1/4 of the Northwest 1/4, all in Section 20, Town 4 North, Range 18 East, Village of East Troy, Walworth County, Wisconsin.

Surveyed for: Bielinski Bros. Builders Inc./ Nancy Fica

Suggested yard grade per grading plan: 857.4

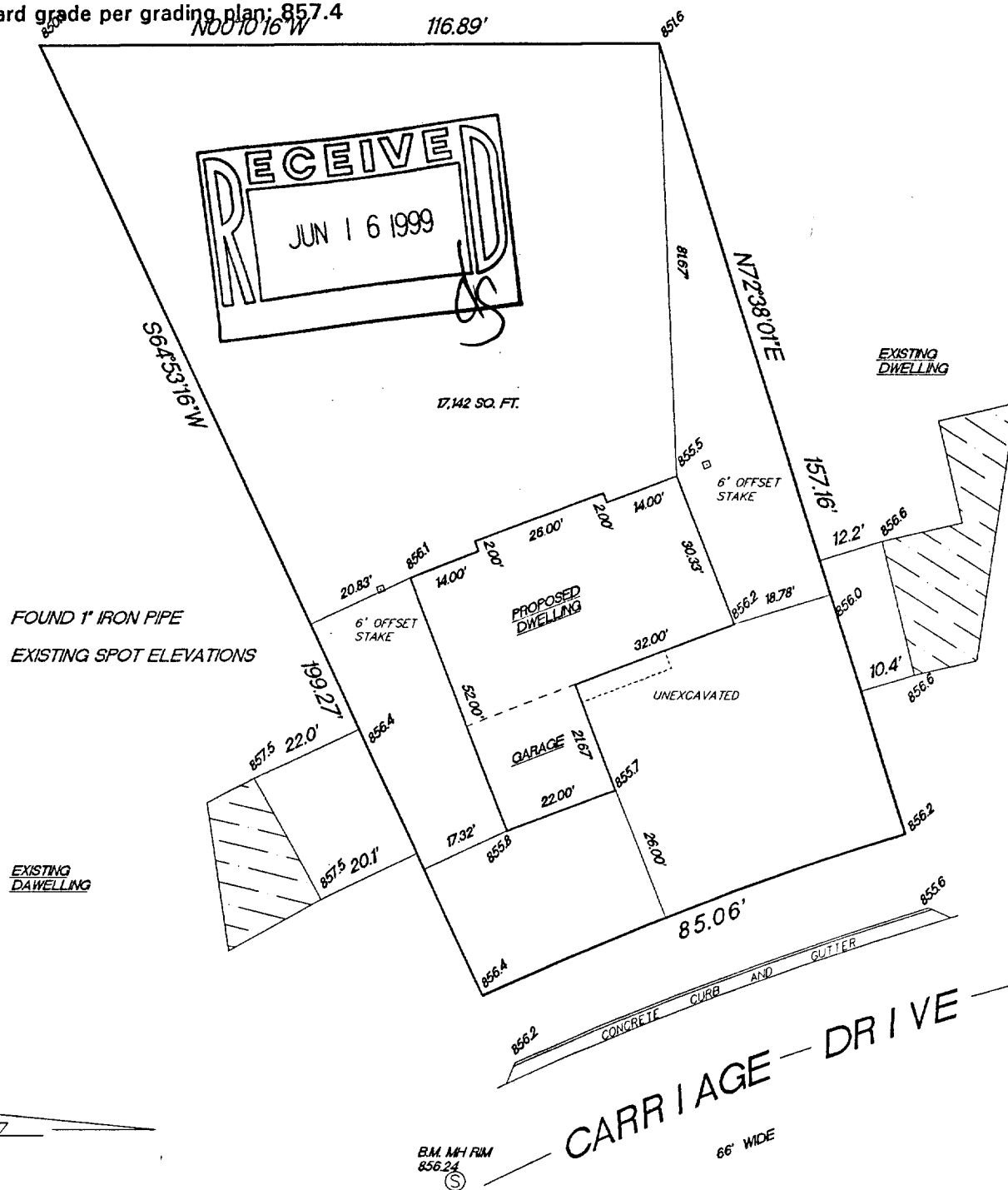

FOUND 1" IRON PIPE  
EXISTING SPOT ELEVATIONS

EXISTING  
DWEELLING

SCALE 1"=30'

RADIUS	LENGTH	CHORD	BEARING	DELTA
629.22'	85.06'	85.00'	S21°14'20.5"E	07°44'45"

"I hereby certify that I have surveyed the above described property and that the above map is a true representation thereof and shows the size and location of the property, its exterior boundaries, the location of all visible structures and dimension of all principal buildings thereon, boundary fences, apparent easements, roadways and encroachments if any."

"This survey is made for the use of the present owners of the property, and also those who purchase, mortgage or guarantee the title thereto within one year from date hereof."



W356 S9050 Godfrey Lane  
P.O. Box 357  
Eagle WI. 53119

(414) 594-3484  
fax (414) 594-5904

THIS IS NOT AN ORIGINAL SURVEY UNLESS THE SEAL IS RED.

6/15/99  
DATE

TEP/DW  
FIELD WORK BY

TEP  
DRAWN BY

99160  
JOB NUMBER

RST01-11 003-621